

KENTUCKY DEPARTMENT OF HIGHWAYS

ANDERSON COUNTY

CENTRAL KENTUCKY PARKWAY

C.K.P. OVER KENTUCKY RIVER

SUBSTRUCTURE - ABUTMENTS 1N & IS

FOR: SMITH, POLLITTE & ASSOC. CONSULTING ENGRS.

PLANS PREPARED BY: C. M. PROBERTH CONSULTING ENGR.

REFERENCE AND ESTIMATE OF QUANTITIES						
ITEM	SHEET NO.	CONCRETE CLASS 'A'	REINFORCING STEEL	STRUCTURE EXCAVATION		G. PIPE UNDERDRAINS
		Cu. Yds.	Lbs.	COMMON Cu. Yds.	SOLID ROCK Cu. Yds.	Lin. Ft.
Title Sheet	1					
Layout	2					
Abutment 1N	3,4	180.1	18,732	—	485	45
Abutment IS	3,4	180.1	18,732	—	455	45
Soundings	5					
TOTAL		360.2	37,464		940	90

Note:
Abutments 1N & IS only are included in the Grade and Drain Contract for Central Kentucky Parkway, Anderson Co., Section 5-1. Abutment construction to El. 644.977 only shall be included in this contract. The Abutments are to be completed by March 1, 1965.

GENERAL NOTES

SPECIFICATIONS: KENTUCKY DEPARTMENT OF HIGHWAYS, CURRENT STANDARD WITH AMENDMENTS.
DESIGN LOAD: BRIDGE DESIGNED FOR H20-S16A LOADING, AS SPECIFIED IN 1961 AASHTO SPECIFICATIONS.
DESIGN STRESSES: FOR REINFORCED CONCRETE,
 f_c -----20,000 psi f_s -----1,200 psi f_t -----3,000 psi.
 u -----200 psi for embedment u -----300 psi for Σ n -----10

FOUNDATION PRESSURE: FOOTINGS ARE DESIGNED FOR A MAXIMUM PRESSURE OF 20,000 psf. for GROUP 1 LOADS WITH INCREASES ALLOWED FOR OTHER LOADING GROUPS.
CONCRETE: CLASS "A" CONCRETE IS TO BE USED THROUGHOUT.

REINFORCEMENT: INTERMEDIATE OR HARD GRADE REINFORCEMENT SHALL BE USED IN ACCORDANCE WITH ASTM A15-58T FOR BILLET STEEL, OR A16-59T FOR RAIL STEEL, CONFORMING TO BENDING REQUIREMENTS OF AASHTO SPECIFICATIONS M21 DIMENSIONS SHOWN FROM FACE OF CONCRETE TO BARS ARE CLEAR DISTANCES. SPACING OF BARS IS FROM CENTER TO CENTER OF BARS.

BEVELED EDGES: ALL FINISHED EDGES SHALL BE BEVELED 7/8" UNLESS OTHERWISE SHOWN.

PIPE UNDERDRAINS: PIPE UNDERDRAINS SHALL BE IN ACCORDANCE WITH SECTION 6.14 OF THE SPECIFICATIONS USING 6" PERFORATED CORRUGATED METAL PIPE U.S. GAGE #16 MEETING THE REQUIREMENTS OF SECTION 7.11 OF THE SPECIFICATIONS. POROUS BACKFILL SHALL BE NO. 6 COARSE AGGREGATE IN ACCORDANCE WITH SECTION 7.4 OF THE SPECIFICATIONS.

COOPERATION WITH ADJACENT CONTRACTOR: THE CONTRACTOR SHALL ARRANGE HIS WORK AND SHALL PLACE AND DISPOSE OF THE MATERIAL BEING USED SO AS NOT TO INTERFERE WITH THE OPERATION OF THE CONTRACTOR ON PROJECT CK 5-2 FOR THE BRIDGE PIERS, BEGINNING AT STATION 3484+00 IN ACCORDANCE WITH THE SPECIFICATIONS.

DESIGNED BY: DATE: 3-5-64
 CHECKED BY: DATE: 3-5-64
 DRAWN BY: DATE: 3-5-64
 IN CHARGE BY: DATE: 3-5-64

NOTES & QUANTITIES

Central Kentucky Parkway over Kentucky River Sheet 1 of 5

COMMONWEALTH OF KENTUCKY			
DEPARTMENT OF HIGHWAYS			
FRANKFORT			
COUNTY OF			
ANDERSON			
CENTRAL KENTUCKY PARKWAY			
ELIZABETHTOWN-VERSAILLES			
ROAD			
ABUT. STATION 3483+13	PROJECT NO. 5P-3-61		
BRIDGE NUMBER	Section 5-1	DRAWING NO. 1580G	DATE

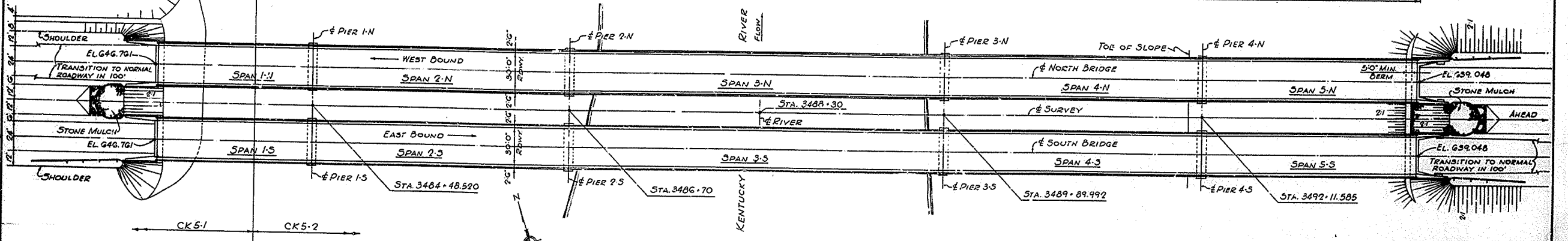
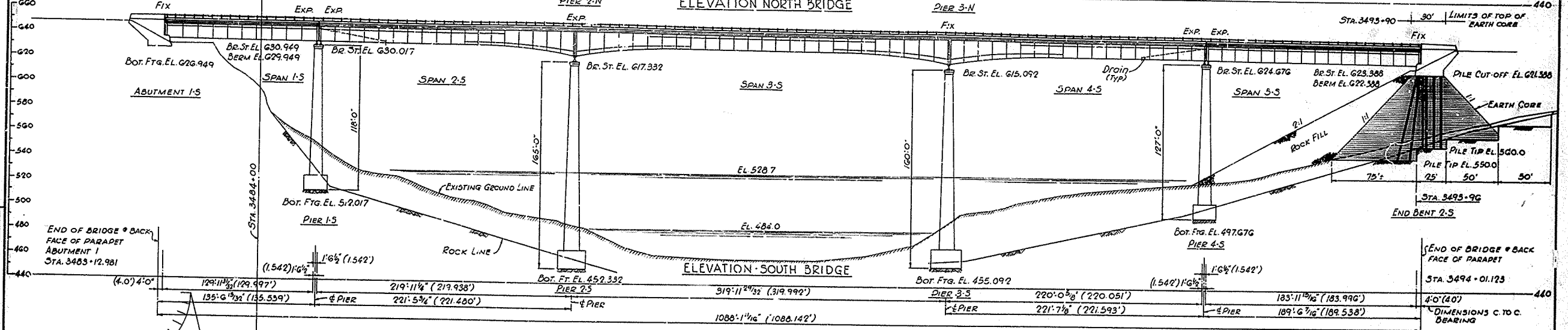
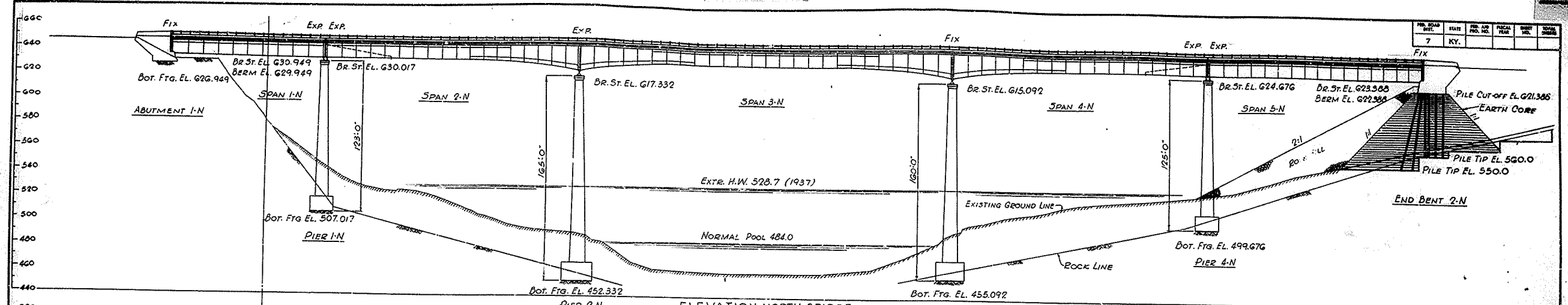

ROADWAY PROFILE

PLAN

TWIN, 130' SIMPLE, 220'-320'-220' CONTINUOUS, 184' SIMPLE
 WELDED R GIRDER SPANS
 30'-0" ROADWAY 2:1 FILL SLOPES 108' SHOULDERS
 H20 SIG-44 OR ALTERNATE LOADING

LAYOUT

Central Kentucky Parkway over Kentucky River Sheet 2

COMMONWEALTH OF KENTUCKY
 DEPARTMENT OF HIGHWAYS
 FRANKFORT
 COUNTY OF
ANDERSON
 CENTRAL KENTUCKY PARKWAY
 ELIZABETHTOWN-VERSAILLES
 ROAD

ADUT. STATION 3485+13 PROJECT NO. DRAWING NO. 15806

BRIDGE NUMBER Section 5-1

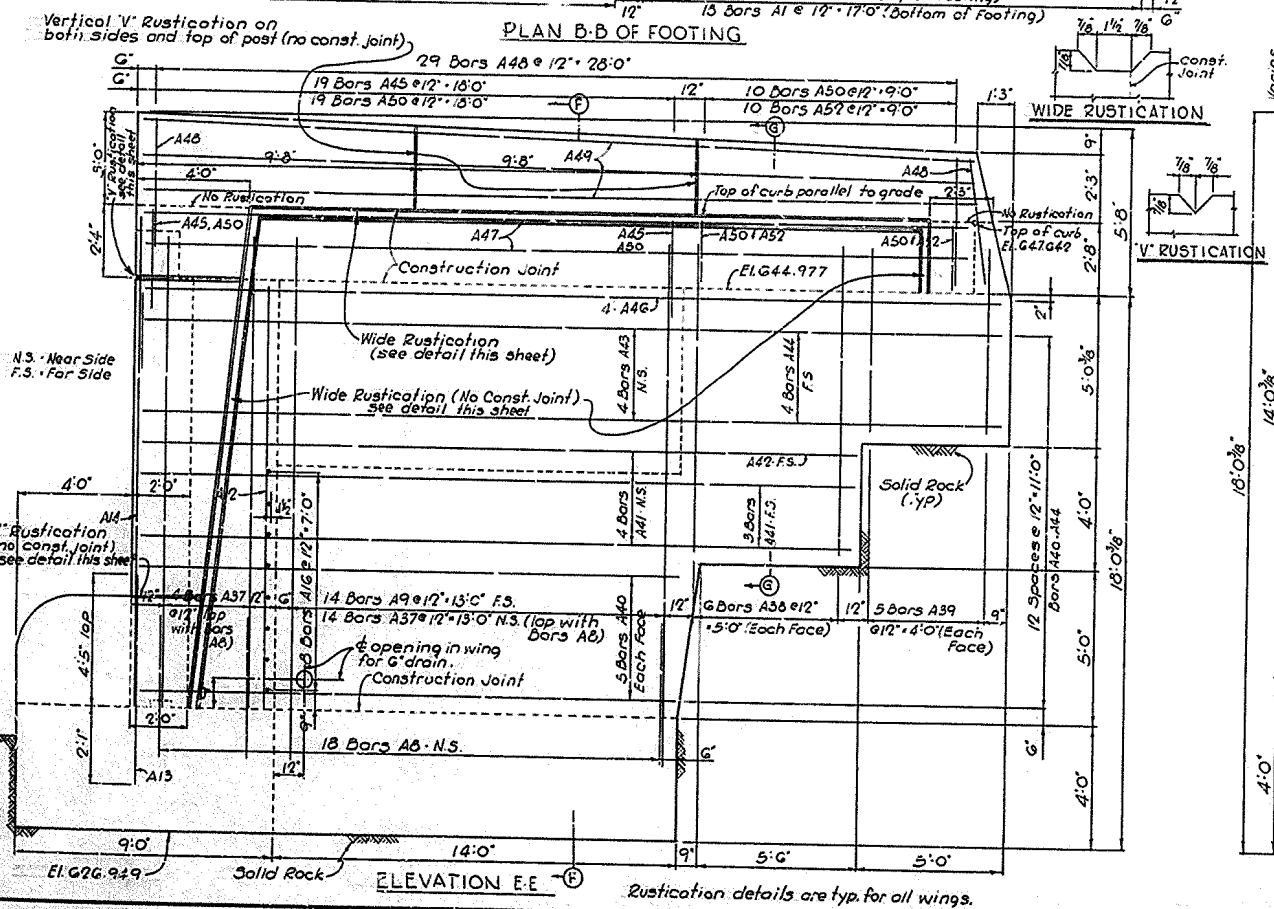
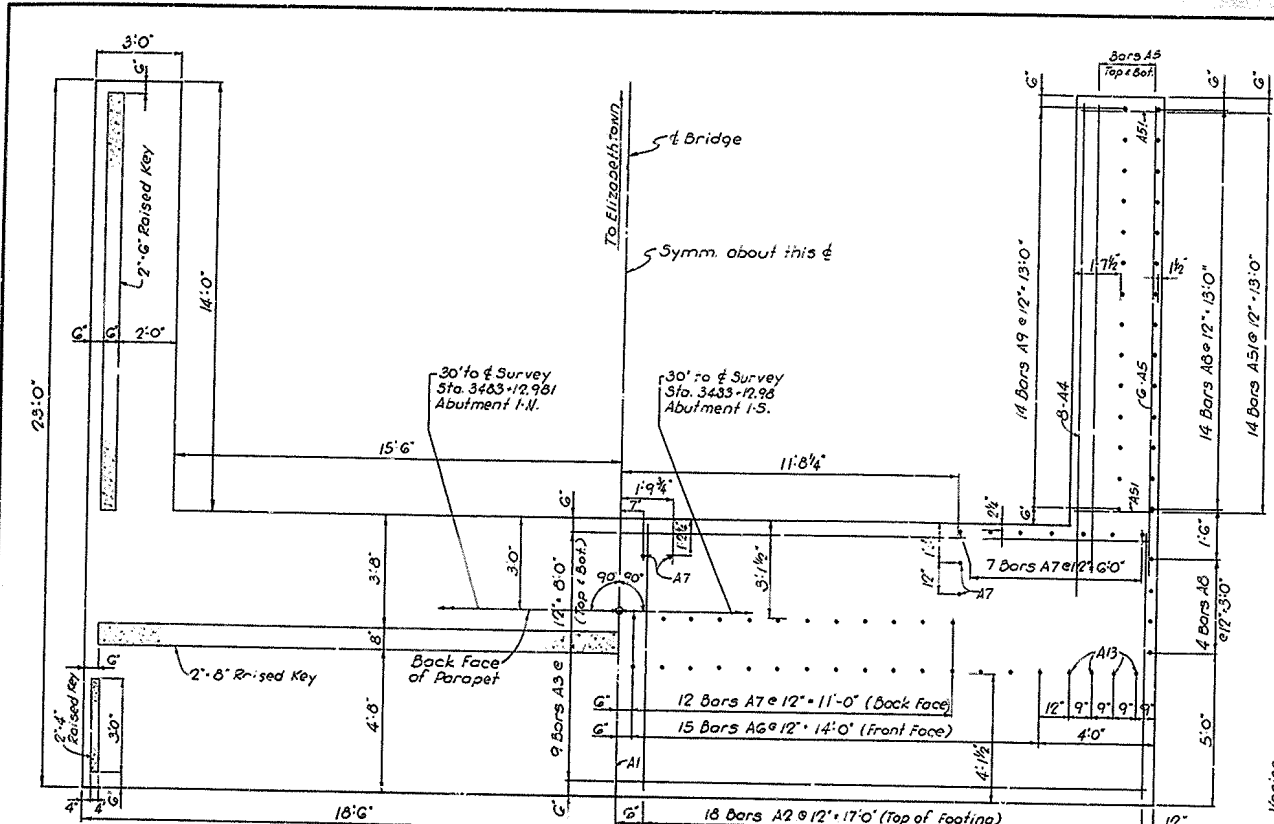

BILL OF REINFORCEMENT

No.	TYPE	NUMBER	LENGTH	LOCATION	ft. in.				No.	TYPE	NUMBER	LENGTH	LOCATION	ft. in.									
					0	b	c	d						0	b	c	d						
A1	(1)	37	9' 4"	Footing	0	5	0	11	0	6	0	8	A27	(7)	2	2	16	7	Haunch	3	4		
A2	Sfr	36	8' 8"										A28	2	2	15	6		5	0			
A3		18	8' 8"										A29	2	2	15	0		4	9			
A4		16	16'										A30	2	2	14	4		4	5			
A5		24	15' 3"										A31	2	2	13	10		4	2			
A6		30	7' 5"	Footing to Parapet									A32	2	2	13	2		3	10			
A7	(1)	46	8' 9"		7	0	1	9	0	11	7	5	A33	2	2	12	8		3	7			
A8	Sfr	36	7' 4"	Footing to Wing									A34	2	2	12	0		3	3			
A9		28	7' 11"										A35	2	2	11	6		3	0			
A10	(2)	30	10'	Parapet									A36	Sfr	4	4	11	6					
A11	(3)	24	9' 14"		13	10	1	3					A37	36	56	7	15	10					
A12	Sfr	11	13' 10"										A38	24	24	10	6						
A13		8	8' 6"	Footing to Parapet									A39	20	20	6	6						
A14		8	8' 6"	Parapet									A40	20	20	18	8						
A15		28	5' 36"										A41	14	14	24	11						
A16	(4)	16	11' 11"										A42	2	2	7	9						
A17	(5)	14	24' 3"	Haunch									A43	8	8	29	11						
A18	(6)	13	12' 2"	Parapet									A44	8	8	12	9						
A19	Sfr	4	7' 8"	Haunch									A45	(3)	38	38	6	2	Curb	2	3	4	0
A20		4	11' 8"										A46	(3)	8	32	3	Wing	29	9	2	8	
A21		4	14' 8"										A47	14	14	10	6	Post	0	19	4	1	
A22		6	15' 5"										A48	8	8	10	6	Post	0	19	4	1	
A23	(7)	2	18' 5"										A49	17	17	10	6	Post	0	19	4	1	
A24		2	17' 10"										A50	(3)	38	4	3	Curb	1	8	2	2	
A25		2	17' 4"										A51	(3)	28	13	8	Footing	2	9	3	9	
A26		2	16' 8"										A52	(3)	20	5	8	Curb	2	9	3	9	
A27		7	16' 7"										A53	7	6	4	9	7	Stub Wall	4	6	0	9
A28		8	5' 0"										A54	Sfr	8	4	5	0					
A29		11	4' 8"										A55	11	4	4	8	7					
A30		12	1' 2"										A56	12	10	1	2	Post					
A31		4	5' 8"										A57	4	4	5	8	8	Parapet				

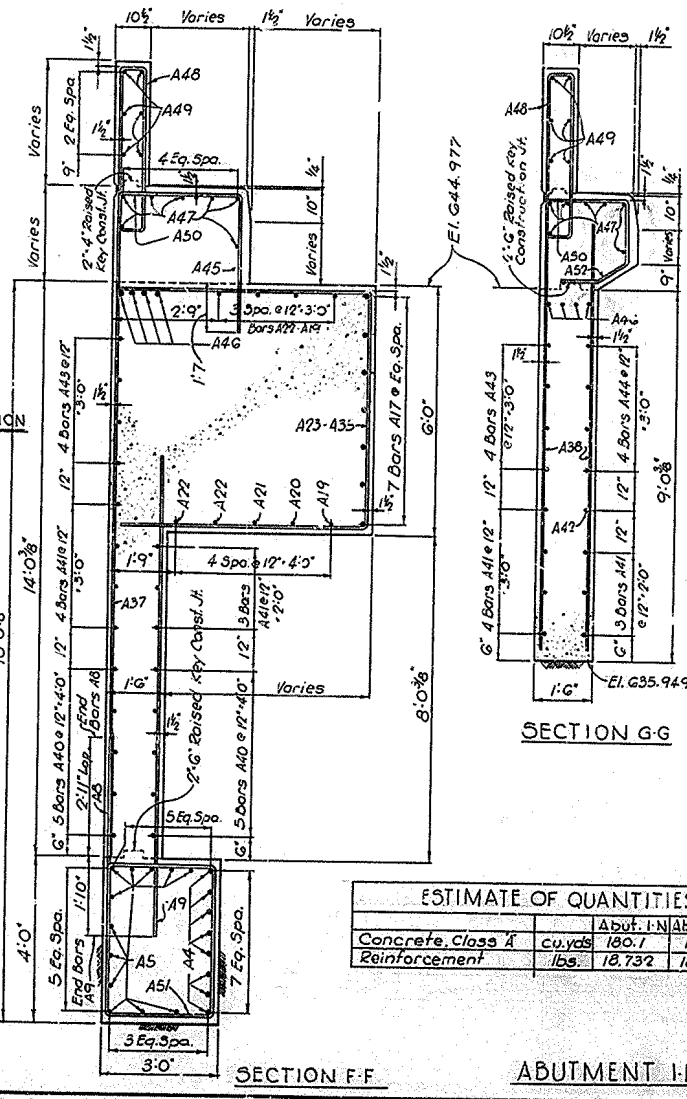

ESTIMATE OF QUANTITIES		
	Abut. I-N	Abut. I-S
Concrete, Class A	cu. yds. 180.7	180.1
Reinforcement	lbs. 18,732	18,732

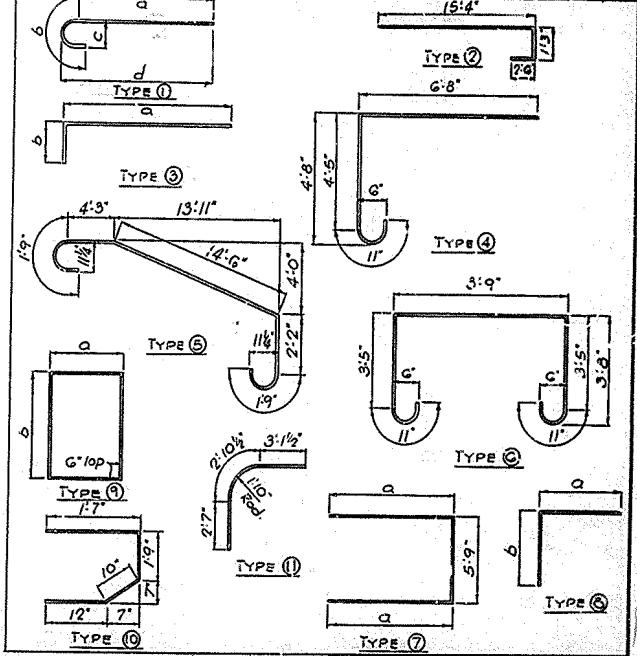

Central Kentucky Parkway over Kentucky River Sheet 4

COMMONWEALTH OF KENTUCKY
 DEPARTMENT OF HIGHWAYS
 FRANKFORT
 COUNTY OF
ANDERSON
 CENTRAL KENTUCKY PARKWAY
 ELIZABETHTOWN - VERSAILLES
 ROAD

ABUT. STATION 3483+13 PROJECT NO. []
 BRIDGE NUMBER 5-1 DRAWING NO. 1580G

REVISIONS
 NO. DATE BY
 1. 12/1/54 J.E.H. HANFORD
 2. 1/1/55 J.E.H. HANFORD
 3. 2/1/55 J.E.H. HANFORD
 4. 3/1/55 J.E.H. HANFORD
 5. 4/1/55 J.E.H. HANFORD
 6. 5/1/55 J.E.H. HANFORD
 7. 6/1/55 J.E.H. HANFORD
 8. 7/1/55 J.E.H. HANFORD
 9. 8/1/55 J.E.H. HANFORD
 10. 9/1/55 J.E.H. HANFORD
 11. 10/1/55 J.E.H. HANFORD
 12. 11/1/55 J.E.H. HANFORD

NO. ROAD DIST.	STATE	FEED. AND PROJ. NO.	SCALE	SHEET NO.	TOTAL SHEETS
7	KY.				

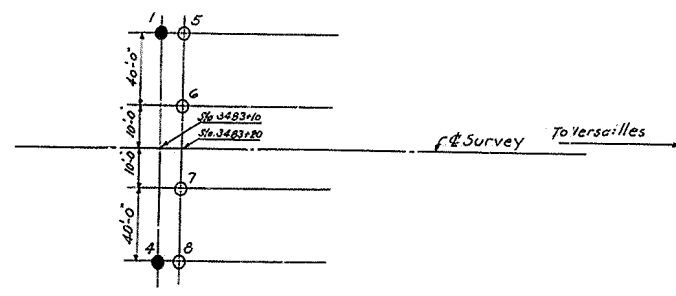

○ Auger Soundings
● Core to Elev. 620

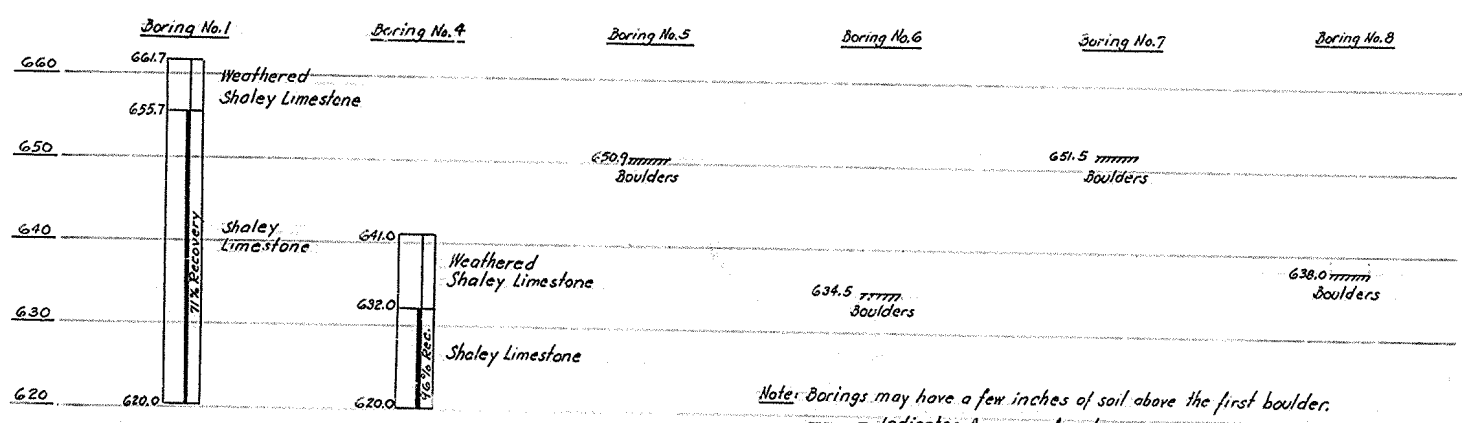
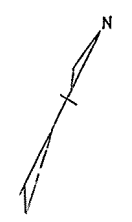

DESIGNED BY	CHECKED BY	DATE	REVISION
BY	BY	BY	BY
DATE	DATE	DATE	DATE
APPROVED BY	CHECKED BY	DATE	REVISION
BY	BY	BY	BY
DATE	DATE	DATE	DATE

SOUNDINGS

Central Kentucky Parkway over Kentucky River Sheet 5

COMMONWEALTH OF KENTUCKY
DEPARTMENT OF HIGHWAYS
 FRANKFORT
 COUNTY OF
ANDERSON
 CENTRAL KENTUCKY PARKWAY
 ELIZABETHTOWN-VERSAILLES

ABUT. STATION 3483+15 PROJECT NO. NO. 1500G

BRIDGE NUMBER Section 5-1 DRAWING NO. DATE